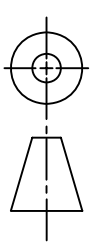
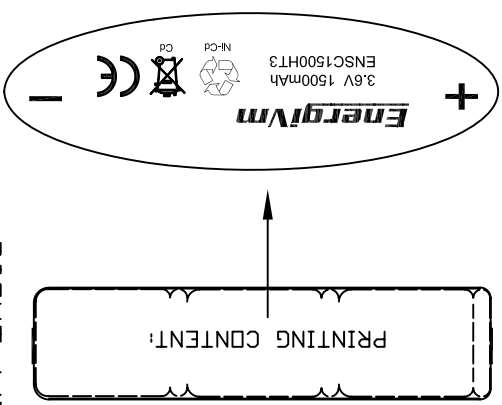
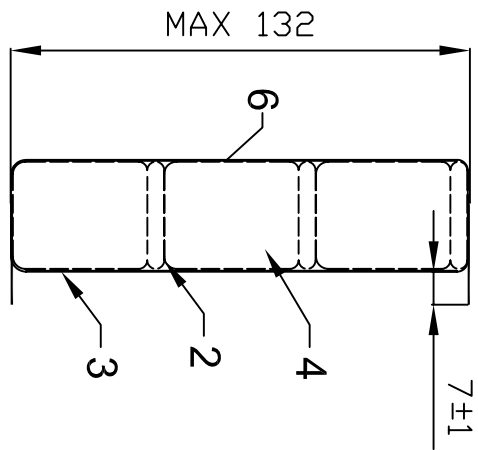
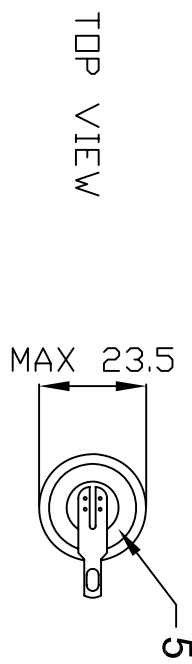

INTRALINK RELEASE LEVEL  
**MASS PRODUCTION**  
 THIRD ANGLE PROJECTION

A2	INCREASED PRINTING CONTENT	18-12-10
A1	FIRST RELEASE	18-11-10
REV	CHANGE DETAIL	DATE

CAT: HIGH TEMP NICD RECHARGEABLE		DRAWN BY: ALVIN FENG 18-12-10
DWG NO. : BZ-0758	REV NO. : A2	CHECKED BY: RITA LIM 18-12-10
PART NO. : SC1500HT-S3S	DESC : High Temp NICD Battery Pack (X3)	APPROVED BY: SIMON TANG 18-12-10
PAGE 1 OF 1		

REF	DESCRIPTION	QTY	REMARKS
6	PAPER CYLINDER	1	SCX3
5	SINGLE CELL INSULATION PLATE	3	WHITE
4	SINGLE CELL	3	SC1500HT
3	BATTERY PACK PVC	1	WHITE
2	CONNECTION TAB	2	
1	OUTPUT TERMINAL	2	YCP-042

NOTE :  
 1. NOT TO SCALE  
 2. ALL DIMENSIONS IN MM  
 3. ALL TOLERANCE ARE +/- 0.15MM UNLESS OTHERWISE SPECIFIED

This document contains Great Energy proprietary data, and is not to be copied, reproduced, used or divulged to unauthorized persons, in whole or in part, without proper authorization in writing from Great Energy. This information is the property of Great Energy which reserves all rights to it.